

ZEMIC TANK MOUNT LOADCELLS

MOUNTING KIT for SHEAR BEAM load cells

Hot worked galvanized mounting kit designed for silos, mixing machines, tanks, hoppers subject to vibrations because of parts in motion. Provided with a ball joint, adjustable height, against lateral forces and anti-tilt to compensate for misalignment of the support plates.

Application ranges from 3ton up to 50ton tanks

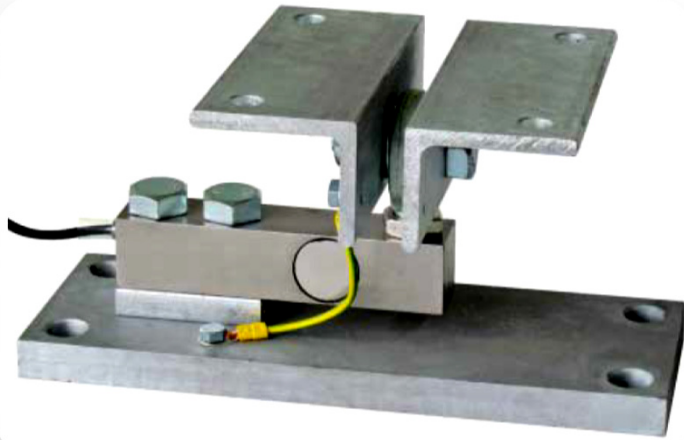

DESCRIPTION

- Hot worked galvanized (PS) or AISI 304 stainless steel (PS10T) upper plate.
- Lower plate and block in hot worked galvanized.
- Constraint against lateral forces and anti-tilt by ball-and-socket joint.
- Misalignment compensation of the support plates structure.
- Adjustable height.

Mounting specifications:

- Complete top & bottom assembly
- Mild steel galvanized
- Bearing eye bolt
- 8mm x 100x50 Angle iron
- 5mm Spacer
- 20mm x 120mm x (175mm - 275mm) Flat-bar

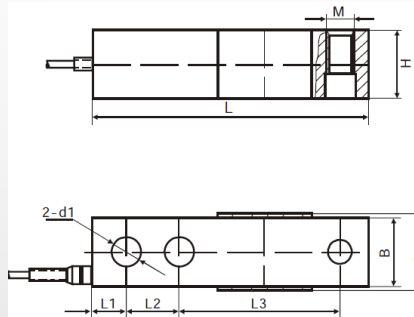

Specifications

| | | | | |
|--------------------------------------|--------------|-----------------|--------------------------------------|--------------------------------|
| Accuracy Class | OIML R60 C3 | NTEP III, III L | Temperature effect on zero (%FS/10C) | 0.018 |
| Rated output (mV/V) | 3.0 ± 0.003 | | Temperature, Compensated (C) | -10 ~ +40 |
| Combined error (%FS) | 0.02 | | Temperature, Operating (C) | -35 ~ +65 |
| Non-linearity (%FS) | 0.02 | | Excitation, Recommended (V) | 5-12(DC) |
| Non-repeatability (%FS) | 0.01 | | Excitation, Max. (V) | 18(DC) |
| Creep (%FS/30min) | 0.02 | | Safe Overload (%FS) | 150 |
| Input Resistance (Ω) | 350 ± 3.5 | | Ultimate Overload (%FS) | 300 |
| Output Resistance (Ω) | 350 ± 3.5 | | Protection Class | IP 67 |
| Insulation Resistance (MΩ) | >5000(50VDC) | | Cable Length (m) | 4(0.5-2t), 6(2.5-10t) 1-20K |
| Zero Balance (%FS) | 1.0 | | Cable spec | 4-wire shielded PU cable φ 5mm |
| Temperature effect on span (%FS/10C) | 0.014 | | | |

Connections Red Input(+) Black Input(-) Green Output(+) White Output(-) Transparence (Shield)

| Dimensions Capacity | L | L1 | L2 | L3 | H | B | B1 | d 1 | M |
|------------------------|-------|------|------|-------|------|------|------|-------|------------|
| 0.5-2t | 130 | 15.8 | 25.4 | 76.2 | 31.8 | 31.8 | 34 | 13.5 | M12 x 1.75 |
| 2.5-5t | 171.5 | 19.1 | 38.1 | 95.3 | 38.1 | 38.1 | 40 | 19.8 | M18 x 1.5 |
| 10t | 222.3 | 25.4 | 50.8 | 120.7 | 50.8 | 50.8 | 52.4 | 26.92 | M24 x 2 |

| Capacity | Accuracy | Part-Number |
|----------|----------|-----------------|
| 500 kg | C3 | H8C-C3-500kg-4B |
| 1t | C3 | H8C-C3-1.0t-4B |
| 2t | C3 | H8C-C3-2.0t-4B |
| 3t | C3 | H8C-C3-3.0t-6B |
| 5t | C3 | H8C-C3-5.0t-6B |
| 10t | C3 | H8C-C3-10t-6B |

